

BUCKET CLAMP (OR THUMB)

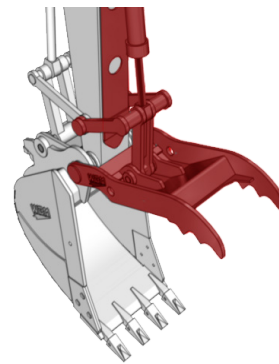

The WBM Bucket Clamp (or thumb) is commonly used for forestry, construction, demolition, road construction and mining applications. This attachment can be added to any bucket, blade or rake to increase its effectiveness to grab and move objects.



**Hydraulic Strut
Progressive Link**

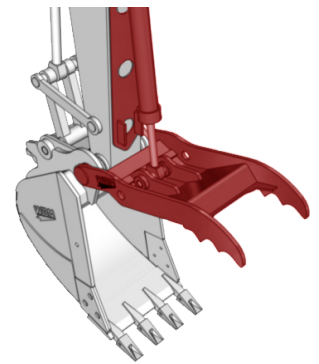

**Hydraulic Strut
Non-Link**

FEATURES & BENEFITS

- Universal design utilizing WBM wedge coupler and generic buckets
- Heavy duty construction
- Adds versatility to excavator operation
- Enables the operator to clamp & grab material (brush, boulders, etc)
- Able to place material (logs, poles, etc) with precision
- Increases payload and efficiency of machine

Continued on next page >>

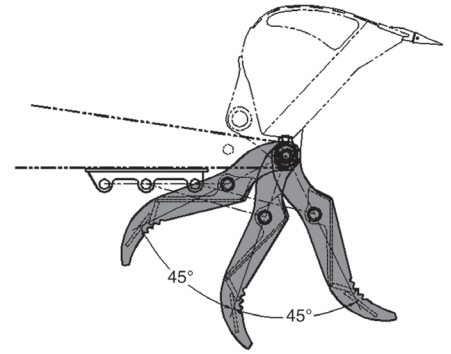
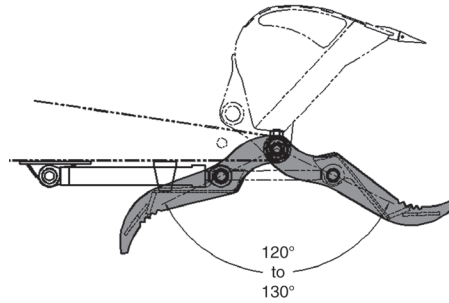
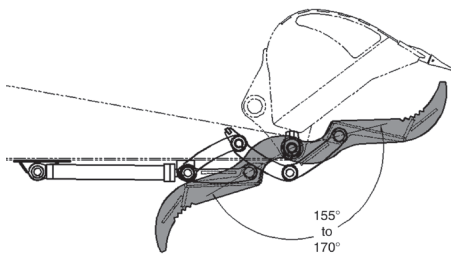

HYDRAULIC STRUT BUCKET CLAMPS

WBM PART #: 123-523-xxxx

MACHINE SERIES	WBM MODEL #	DESCRIPTION	WEIGHT (lbs)
EX80	EX80-HBC-2TN	BUCKET CLAMP: NO LINK	365
EX120	EX120-HBC-2TN	BUCKET CLAMP: NO LINK	750
EX150	EX150-HBC-2TN	BUCKET CLAMP: NO LINK	850
EX200	EX200-HBC-2TN	BUCKET CLAMP: NO LINK	1,250
EX250	EX250-HBC-2TN	BUCKET CLAMP: NO LINK	1,385
EX300	EX300-HBC-2TN	BUCKET CLAMP: NO LINK	1,700
EX400	EX400-HBC-2TN	BUCKET CLAMP: NO LINK	2,560

Hydraulic Strut Bucket Clamps include thumb weldment with pin, heavy duty cushioned cylinder, weld-on cylinder anchor, backing plate and mechanical rotation stops. Please contact your local WBM rep for lugging options.

ADDITIONAL TINE OPTION

MACHINE SERIES	WEIGHT (lbs)
EX80	15
EX120	27
EX150	40
EX200	47
EX250	84
EX300	125
EX400	150

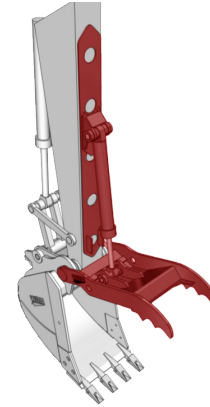

HYDRAULIC PROGRESSIVE LINK BUCKET CLAMPS

WBM PART #: 123-572-xxxx

MACHINE SERIES	WBM MODEL #	DESCRIPTION	WEIGHT (lbs)
EX120	EX120-PBC-2TN	BUCKET CLAMP: W/LINK	975
EX150	EX150-PBC-2TN	BUCKET CLAMP: W/LINK	1,200
EX200	EX200-PBC-2TN	BUCKET CLAMP: W/LINK	1,400
EX250	EX250-PBC-2TN	BUCKET CLAMP: W/LINK	1,900
EX300	EX300-PBC-2TN	BUCKET CLAMP: W/LINK	2,400
EX400	EX400-PBC-2TN	BUCKET CLAMP: W/LINK	3,060

Progressive Link Bucket Clamp Includes thumb weldment with pin, heavy duty cushioned cylinder, progressive link (idler and power links), weld-on cylinder anchor, backing plate and mechanical rotation stops. Please contact your local WBM rep for lugging options.

ADDITIONAL TINE OPTION

MACHINE SERIES	WEIGHT (lbs)
EX80	15
EX120	27
EX150	40
EX200	47
EX250	84
EX300	125
EX400	150

