



The improved “Max-View” WBM Mat Grapple for wheel loaders is used to remove and place mats, which protect the environment and extend the construction season. This enables safe access for crews and heavy equipment.

FEATURES AND BENEFITS

- Short back fork tines improve operator visibility of fork tines at ground and deck level
- Low profile fork rack provides enhanced view to tine tips
- Tall side plates provide increased load stability when transporting multiple mats
- Full length fork positioning uses chain with a quick pin to support multiple fork tine positions
- Larger hanger shaft design supports maximum mat carrying capability
- Cylinder hoses routed through frame for improved protection
- Removeable cover plate helps protect jump hose connections
- Box-type overarm construction decreases weight, improves durability and visibility, while providing interference ‘free’ rollback
- Available with WBM KAT or OEM standard lugging
- Wide overarm with gripping teeth
- Standard fork tine swing lock system
- *Standard mat grapple comes without lights, optional bolt-on light kit available*

Continued »

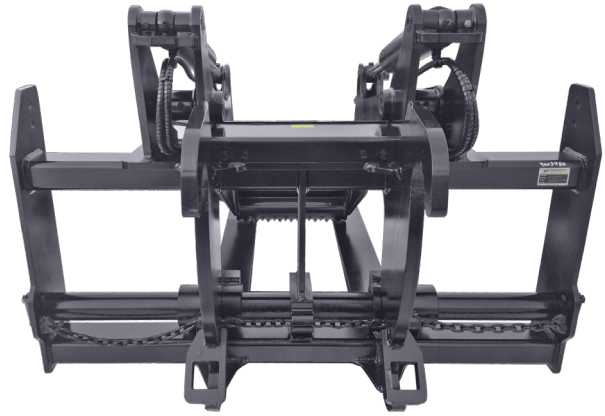

HOSES ROUTED UNDER CYLINDERS TO MINIMIZE HOSE DAMAGE AND INCREASED PROTECTION

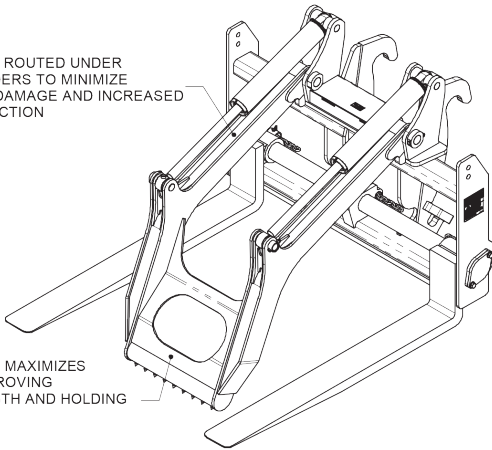

LOW PROFILE FRAME IMPROVES LOAD VISIBILITY

BOLT ON HYDRAULIC COVER PROTECTS HOSES AND JUMP HOSE CONNECTIONS

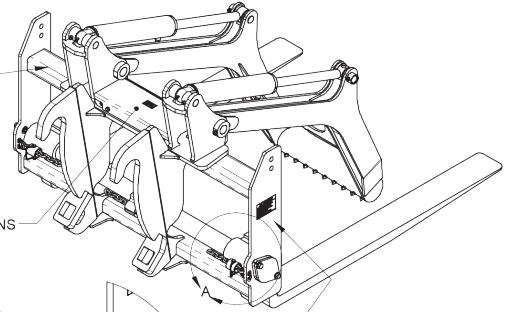

BOX STYLE OVERARM MAXIMIZES VISIBILITY WHILE IMPROVING STRUCTURAL STRENGTH AND HOLDING CAPABILITY

CHAIN POSITIONING WITH QUICK PIN FOR MAXIMUM FORK TINE POSITIONING

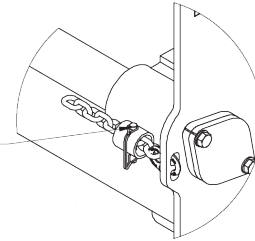

TALL SIDEPLATE DESIGN TO MAXIMIZE MULTIPLE MAT STABILITY

OPTIONAL BOLT ON LIGHT KIT

SHORT BACK FORK TINES IMPROVE VISIBILITY

LARGER HANGER SHAFT IMPROVES LOAD HANDLING CAPABILITIES

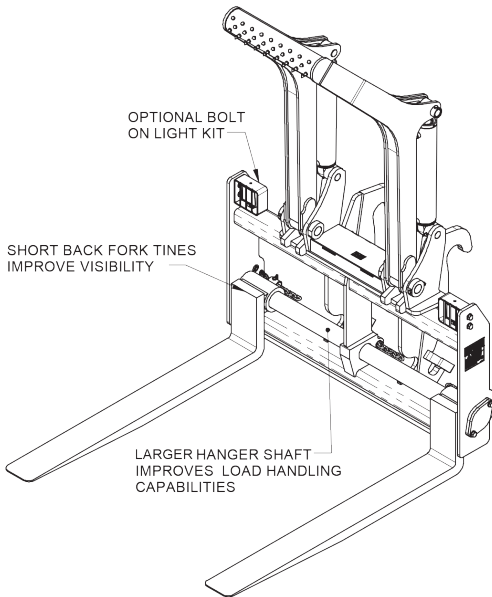

MACHINE SERIES	WBM MODEL #	DESCRIPTION	WEIGHT (lbs)
WL150	WL150-MG-72-2.5	72" Wide; c/w 2.5" x 8" x 72" tines	3,500
WL150	WL150-MG-72-3.5	72" Wide; c/w 3.5" x 8" x 72" tines	4,050
WL175	WL175-MG-72-2.5	72" Wide; c/w 2.5" x 8" x 72" tines	3,500
WL175	WL175-MG-72-3.5	72" Wide; c/w 3.5" x 8" x 72" tines	4,050
WL200	WL200-MG-72-2.5	72" Wide; c/w 2.5" x 8" x 72" tines	4,450
WL200	WL200-MG-72-3.5	72" Wide; c/w 3.5" x 8" x 72" tines	5,500

Grapples come standard with overarms. Comes with WBM or ISO style lugs.